

FOOTREST

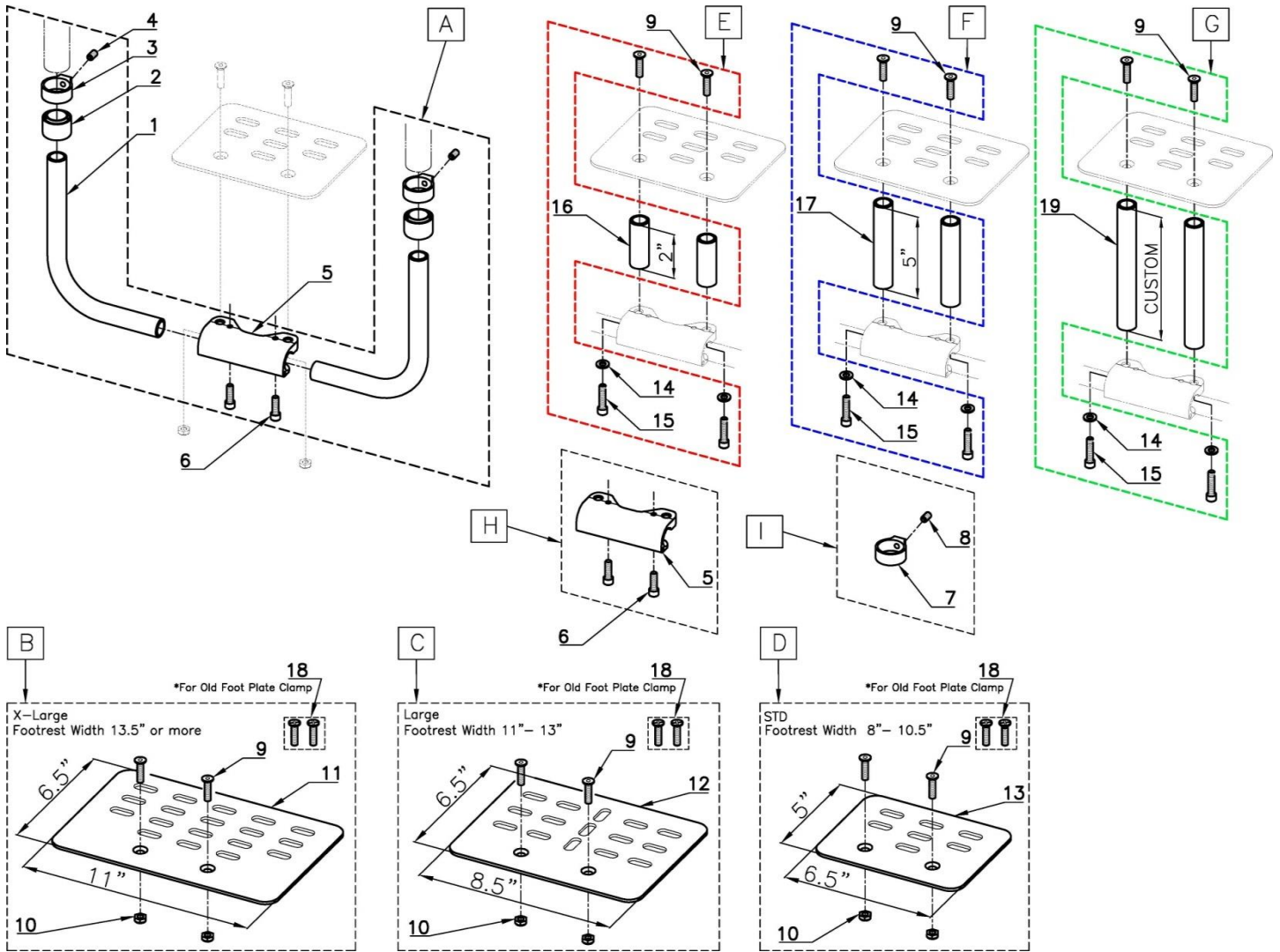

POS	Assy #	#	Parts #	QTY	Color	Remark	MSRP	NOTE
A	2200-01A	1	0416-198	2	Blk	For Footrest Width 8"-9.5"	per set	1set/chair
			0416-199	2	Blk	For Footrest Width 10"-11.5"		
			0416-200	2	Blk	For Footrest Width 12"-13.5"		
			0416-201	2	Sil	For Footrest Width 14"-15.5"		
			0416-202	2	Blk	For Footrest Width 16"-17.5"		
			0416-203	2	Blk	For Footrest Width 18"-19.5"		
		2	0082-300	2	Blk	Plastic Slip Fit Bushing		
		3	0168-301	2	Blk	Footrest Ring		
		4	0256-301	2	Sil	1/4"-28 L:1/2" SS		
5	0416-304	1	Blk	Foot Plate Clamp				
6	0501-300	2	Sil	1/4"-20 L:3/4" SHCS				
B	2200-01B	9	0541-314	2	Blk	1/4"-20 L:3/4 SFHCS	per set	1set/chair
		10	0116-300	2	Sil	1/4"-20 Nylon HLN		
		11	0416-120	1	Blk	X-Large		
C	2200-01C	18	0437-300	2	Sil	1/4"-20 L:1" FHPS	per set	1set/chair
		9	0541-314	2	Blk	1/4"-20 L:3/4 SFHCS		
		10	0116-300	2	Sil	1/4"-20 Nylon HLN		
D	2200-01D	9	0541-314	2	Blk	1/4"-20 L:3/4 SFHCS	per set	1set/chair
		10	0116-300	2	Sil	1/4"-20 Nylon HLN		
		18	0437-300	2	Sil	1/4"-20 L:1" FHPS		
E	2200-01E	9	0541-314	2	Blk	1/4"-20 L:3/4 SFHCS	per set	1set/chair
		14	0277-300	2	Sil	1/4" W		
		15	0110-300	2	Sil	1/4"-20 L:1" SHCS		
F	2200-01F	9	0541-314	2	Blk	1/4"-20 L:3/4 SFHCS	per set	1set/chair
		14	0277-300	2	Sil	1/4" W		
		15	0110-300	2	Sil	1/4"-20 L:1" SHCS		
G	2200-01G	9	0541-314	2	Blk	1/4"-20 L:3/4 SFHCS	per set	1set/chair
		14	0277-300	2	Sil	1/4" W		
		15	0110-300	2	Sil	1/4"-20 L:1" SHCS		
H	2200-01H	5	0416-304	1	Blk	Foot Plate Clamp	per set	1set/chair
		6	0501-300	2	Sil	1/4"-20 L:3/4" SHCS		
		7	0168-301	1	Blk	Footrest Ring		
I	2200-01I	7	0168-301	1	Blk	Footrest Ring	per set	2set/chair
		8	0256-301	1	Sil	1/4"-28 L:1/2" SS		

POS	Assy #	#	Parts #	QTY	Color	Remark	MSRP	Note
D	2200-01D	9	0541-314	2	Blk	1/4"-20 L:3/4 SFHCS	per set	1set/chair
		10	0116-300	2	Sil	1/4"-20 Nylon HLN		
		13	0416-112	1	Blk	STD		
E	2200-01E	18	0437-300	2	Sil	1/4"-20 L:1" FHPS	per set	1set/chair
		9	0541-314	2	Blk	1/4"-20 L:3/4 SFHCS		
		14	0277-300	2	Sil	1/4" W		
F	2200-01F	9	0541-314	2	Blk	1/4"-20 L:3/4 SFHCS	per set	1set/chair
		14	0277-300	2	Sil	1/4" W		
		15	0110-300	2	Sil	1/4"-20 L:1" SHCS		
G	2200-01G	9	0541-314	2	Blk	1/4"-20 L:3/4 SFHCS	per set	1set/chair
		14	0277-300	2	Sil	1/4" W		
		15	0110-300	2	Sil	1/4"-20 L:1" SHCS		
H	2200-01H	5	0416-304	1	Blk	Foot Plate Clamp	per set	1set/chair
		6	0501-300	2	Sil	1/4"-20 L:3/4" SHCS		
		7	0168-301	1	Blk	Footrest Ring		
I	2200-01I	7	0168-301	1	Blk	Footrest Ring	per set	2set/chair
		8	0256-301	1	Sil	1/4"-28 L:1/2" SS		